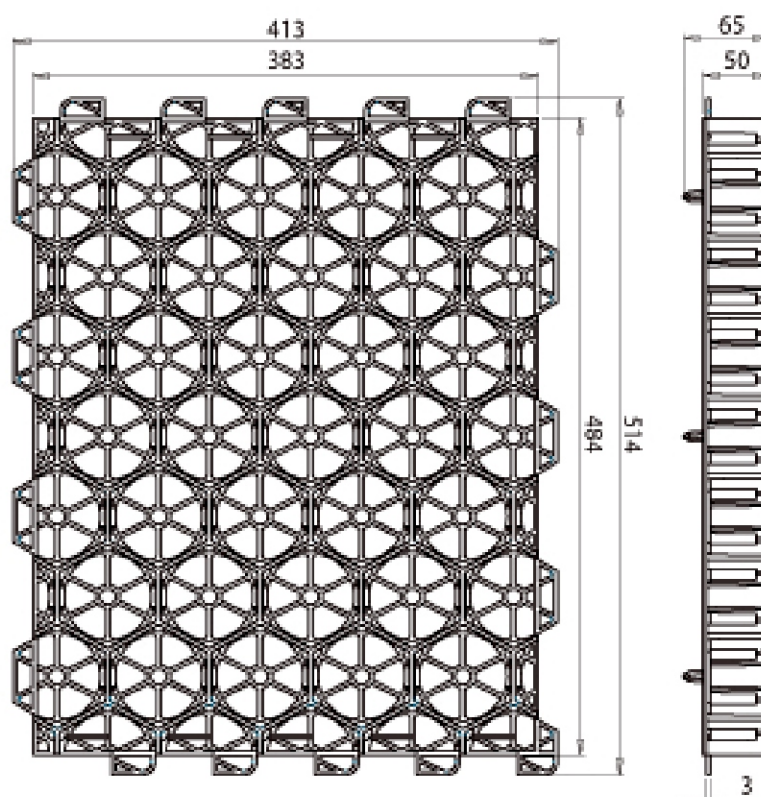

**PRATO****NEXUS****Technical  
sheet****Dimensions and features**

NB: Dimensions and weights are subjected to the normal tolerance of the manufacturing process.

|                         |            |
|-------------------------|------------|
| Length (mm)             | 484        |
| Width (mm)              | 383        |
| External height (mm)    | 50         |
| Stud height (mm)        | 15         |
| Number of studs         | 9          |
| Material                | PP         |
| Weight (Kg)             | 0.800      |
| Pieces per square metre | 5.3 ca.    |
| Standard colour         | Verde      |
| Load capacity (20° C)   | 1.300 kN/m |

**Packaging**

|  |           |
|--|-----------|
| Pallet dimension (mm)                                | 1000x1200 |
| Pallet height for truck with high load capacity (mm) | 2570      |
| Pieces per pallet for truck with high load capacity  | 294       |
| m2 per pallet for truck with high load capacity      | 55.5      |
| Pallet height for semitrailer (mm)                   | 2370      |
| Pieces per pallet for semitrailer                    | 270       |
| m2 per pallet for truck semitrailer                  | 51.0      |

Example:

- a high-load-capacity truck comprises 28 pallets (1000x1200x2570mm) for tot. 8,232 pieces (294 pieces x 28), i.e. 1,554 m<sup>2</sup> (55.5 m<sup>2</sup> x 28)
- a semitrailer comprises 26 pallets (1000x1200x2370mm) for tot. 7,020 pieces (270 pieces x 26), i.e. 1,326 m<sup>2</sup> (51.0 m<sup>2</sup> x 26)

# PRATO

# NEXUS

## Installation

### 1. Preparation of the underlying layer:

the type of underlying layer to be made depends on both the geotechnical characteristics of the ground and the loads affecting the area where PRATO is to be installed. Two different cases are possible:

- a. areas subject to vehicular traffic;
- b. areas subject to pedestrian traffic.

In case a. prepare the ground by making up a 30 cm-thick permeable quarry stabilised material or gravel mixed material to be compacted and levelled perfectly in 10 cm-thick layers - water drainage through the layer must be ensured.

In case b. the preparation is similar to case a., but a 15 cm-thick layer is enough.

### 2. Preparation of NON WOVEN FABRIC installation:

the 400 gr/m<sup>2</sup> Tessuto non Tessuto layer has the double function of preventing weeds from growing out of the layers below and holding the finest parts, which make up the layers above (see Par. 3.) and could be carried by infiltration water, thus making the roadway weaker.

### 3. Preparation of the installation surface:

the installation plane for PRATO will be made of siliceous sand or fine crushed stone with good mechanical resistance and granulometry not above 6/8 mm. This layer, with thickness not lower than 3/4cm, must be properly compacted and levelled.

### 4. Installation of the grass grid MufleDrain “PRATO”:

to carry out this operation just hook to each other the different elements, which have a smaller size and are consequently lighter in weight and easier to handle. No mechanical tools are needed. Assemble the elements by means of staggered joints (male/female). The mortises along the sides of the PRATO grid must be arranged alternatively above and below the mortises of the adjoining element; they must be held in position and the height must be always the same. PRATO can be easily shaped and adapted to all profiles, but 3/4 cm must be left between the obstacle opposite (such as a well, kerb, pavement etc) and the last row of the grid. In order to overcome any grip problems in slopes, each PRATO element has 9 spikes to be driven into the ground that are able to ensure the grid's stability.



Preparation of the underlying layer



Preparation of NON WOVEN FABRIC

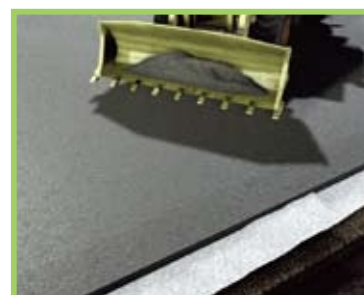

Preparation of the installation surface

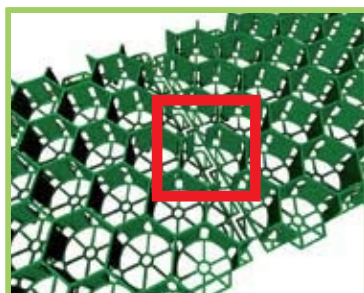

Detail elements joints

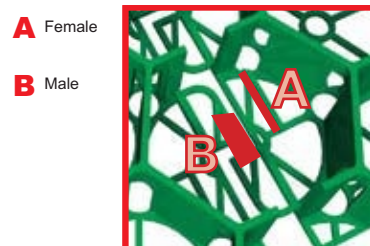

Joint male-female

# PRATO

# NEXUS

## Installation advices:

The installation can be more or less easy according to the ground shape and the surface morphology to cover up; clearly, during installation, a better confidence can be achieved and the job will be speeded up. Here it follows some basic rules for a correct and easy installation:

1. step 1: the orientation of the gratings have to be decided before: position and install the first row of the turf field along all the perimeter length of the surface to be covered.
2. step 2: prepare a second raw in proximity of the first line and push it gently till they fit in properly. The smooth surfaced of the installation joints will help for an easy fitting (rise some millimetres up the first line if necessary)
3. prepare the third row as per point 2 till the coverage of all the surface
4. if a grating is required between other 2 orthogonal already installed gratings (image A), link the short first, then rise a bit the other grating letting fit in the remaining joints

## 6. Filling the cells:

The PRATO cells can be filled with a mixture of vegetable earth, peat and sand or gravel (figures 22 and 23). Before sowing the lawn with high-quality grass seeds, remember to irrigate the whole area in order to lower the soil level by approximately 1 cm and thus to prevent the seeds from getting lost - the seeds must be protected inside the cells.

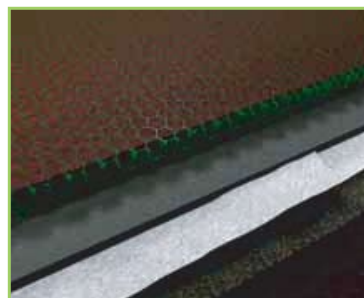
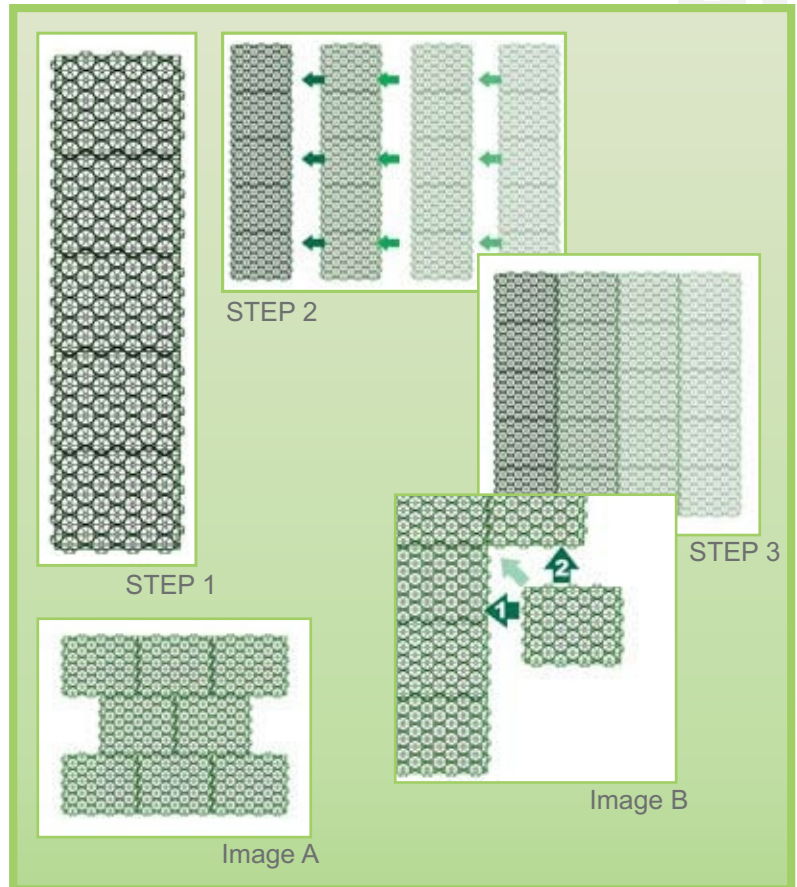

Filling with mixture



Filling with gravel

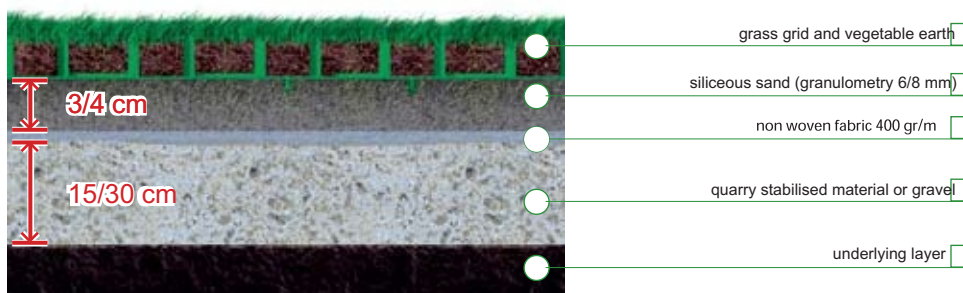

Arrangement of layers

N.B. Do not carry out any installation work (as described under Par. 1, 2 and 3) if the temperature is lower than 2°C.



# Green Grass Grid "PRATO"

Code  
White 519104  
Blue 519105  
Red 519106  
Yellow 519107

# PRATO

# NEXUS

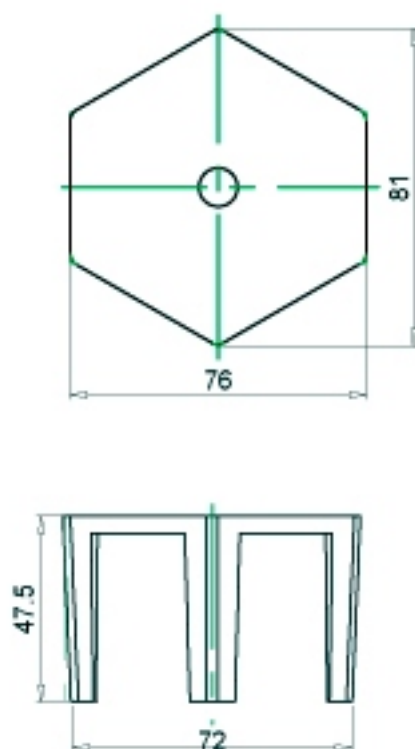

## Data Sheet

### Dimensions and features

NB: Les dimensions et le poids sont établis d'après les tolérances normales de fabrication.

|                      |                           |
|----------------------|---------------------------|
| Length (mm)          | 76                        |
| Width (mm)           | 81                        |
| External height (mm) | 47.5                      |
| Material             | PP (Polypropylen)         |
| Weight (Kg)          | 0.02                      |
| Colours              | Blanc, Jaune, Bleu, Rouge |
| Dimensions box (mm)  | 300x200x100               |
| Pieces per box       | 20                        |